



Dia.82x25mm/3.2inch , 57~25CFM

TDK8225

General specification



- Motor: Brushless DC, auto restart impedance & polarity protected motor
- Motor Case: Glass fiber reinforced PBT thermoplastic, UL94V-0
- Impeller: Glass fiber reinforced PBT thermoplastic, UL94V-0 impeller
- Rotation: CCW looking at rotor, air inlet side of housing
- Bearing System: Double sealed high precision ball bearing
- Operating Temp: Ball bearings -20C ~ +65C
- L10 Life: 70,000 hours at 40C, 60,000 hours at 65C
- Dielectric Strength: 500 VAC/sec. Max leakage 500 micro amp
- Connection: Wire leads connecting AWG24, 300~350mm, stripped ends 3~5mm
- Net Weight: -



Related Technical Information

-Optional Function Leads:

*Alarm, motor stop, cutoff sensor signals (L, run-Low, stop-High for alarm function, color yellow lead)

*Tach speed sensor output, open collector, 2 square waves per revolution, or TTL 4.4~5 VDC optional (T, white lead)

*Speed control:

1.H, NTC thermister thermal control 1800~3400RPM/4.7~10K ohm vs 45~20C(H,orange lead)

2.P, Pulse Width Modulation, microprocessor programmable CPU speed control,10~100%, full stop & 10 speed stages; 800~3800RPM (P, purple lead)

3.V, Control voltage speed setting, Analog 0~10V vs speed RPM speed control via separate DC low voltage interface (V, gray lead)

Fan Performance Curve and Dimension

Dimensions: AxBxCxD: Dia.82x25mm/3.2inch

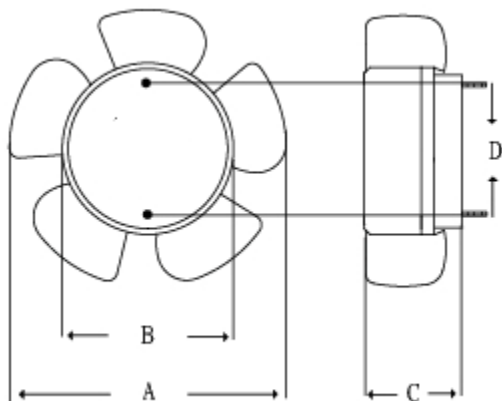

Mounting Screw x2
M3.5 x 0.6P
L: 11.5 +- 1mm

*Screw Length can be changed to meet customer requirement.

* TEI reserves the right to change data and specs without notice* Tests are at nominal voltage against zero static pressure* Specification subject to change without notice, data tolerance +-10%