



Dia.40mm , 106~24CFM

TDCF-040A **General specifications**



- Motor: External rotor, shaded pole, impedance protection
- Casing: Steel Plate housing & frame with black color cosmetics
- Impeller: Aluminum alloy fan blade with natural treatment cosmetics
- Rotation: CCW or CW viewed from side of motor shaft outlet for choice of R or L type
- Bearing System: Permanently lubricated ball bearings for motor and impeller bracket
- Operating Temp: Acceptable -25C~+65C. Storage -30C~+90C (65%RH)
- L10 Life: 35,000 hrs at 45C, 30,000 hrs at 55C.
- Dielectric Strength: Over 1 min. at 500VAC, 50/60Hz
- Insulation Resistance: Over 10 Mega Ohm at DC 500V,
- Connection: Wire leads connecting AWG22, 300~350mm, stripped ends 3~5mm
- Net Weight: See below

Model No.	Rated Voltage	Dimensions AxBxCxD	Bearing	Weight	Rated Current	Referenced Speed	Max. Airflow	Max.Static Pressure			Noise
	VDC	mm	S/B	(grams)	A	RPM	CFM	mmAq	CE	UL	dBA
TDCF-04009A-H-12	12	98x108x144x31	S/B	220	0.20	3000	24	2.9	X		33
TDCF-04009A-H-24	24	98x108x144x31	S/B	220	0.15	3000	24	2.9	X		33
TDCF-04015A-H-12	12	160x170x206x31	S/B	260	0.25	2600	35	2.6	X		31
TDCF-04015A-H-24	24	160x170x206x31	S/B	260	0.20	2600	35	2.6	X		31
TDCF-04019A-H-12	12	198x208x246x38	S/B	310	0.30	2500	49	2.5	X		33
TDCF-04019A-H-24	24	198x208x246x38	S/B	310	0.20	2500	49	2.5	X		33
TDCF-04029A-H-12	12	300x310x348x38	S/B	410	0.40	2300	74	2.0	X		33
TDCF-04029A-H-24	24	300x310x348x38	S/B	410	0.20	2300	74	2.0	X		33
TDCF-04035A-H-12	12	360x310x348x38	S/B	570	0.60	2600	106	2.1	X		42
TDCF-04035A-H-24	24	360x370x416x50	S/B	570	0.40	2600	106	2.1	X		42

Fan Performance Curves and Dimensions

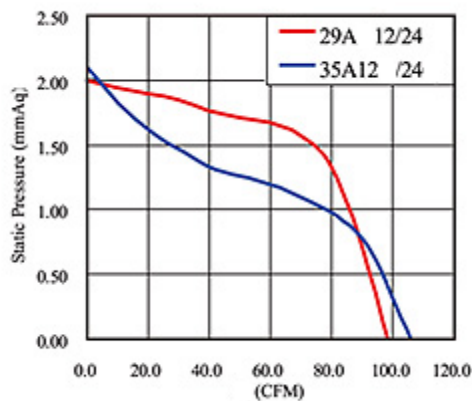
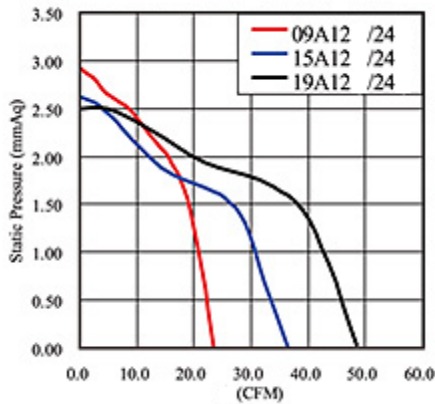
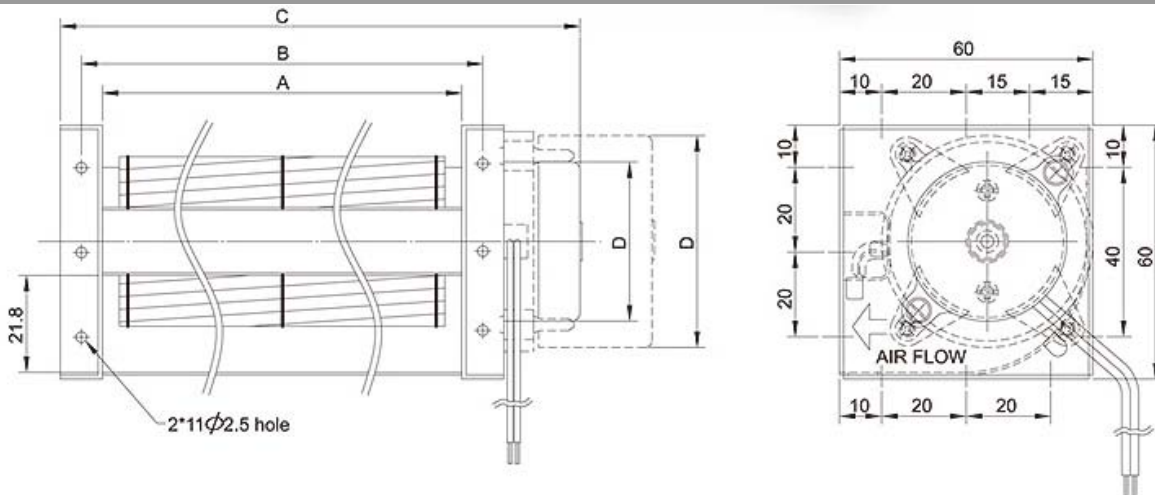

* TEI reserves the right to change data and specs without notice* Tests are at nominal rated voltage against zero static pressure* Specifications subject to change without notice, data tolerance +-10%